

BYLAW 2025-01

Rural Municipality of Lajord No. 128

A BYLAW OF THE RURAL MUNICIPALITY OF LAJORD NO. 128, IN THE PROVINCE OF SASKATCHEWAN, TO AMEND BYLAW NO. 2022-13, KNOWN AS THE ZONING BYLAW

Under the authority granted by *The Planning and Development Act, 2007* (the PDA), the Council of the Rural Municipality of Lajord No. 128 in the Province of Saskatchewan enacts as follows:

- 1. Delete and replace subsection 7.3 1) Other Uses in Section 7.0 Country Residential 1 District (CR1), with the following:**

| | |
|---------------|--|
| 1) Other Uses | Mobile or modular home on a permanent foundation |
| | Convenience stores with or without gas bars |
| | Golf courses |
| | Rinks, arenas, and community halls |
| | Solid and liquid waste disposal facilities |
| | Bed-and-breakfast homes, where ancillary to a residence on the same site |
| | Home-based businesses, where ancillary to a residence on the same site |
| | Dwellings ancillary to an institutional, recreational or commercial Use |
| | Dwelling Groups |
| | Small-Scale Manufacturing Steel Services |
| | Other uses, at Council's discretion, such as Wind Energy Systems |

2. Rezone all that portion of the SE ¼ 23-13-16 W2M shown within the red outlined below, from Agricultural District (A) to Country Residential 1 District (CR1).

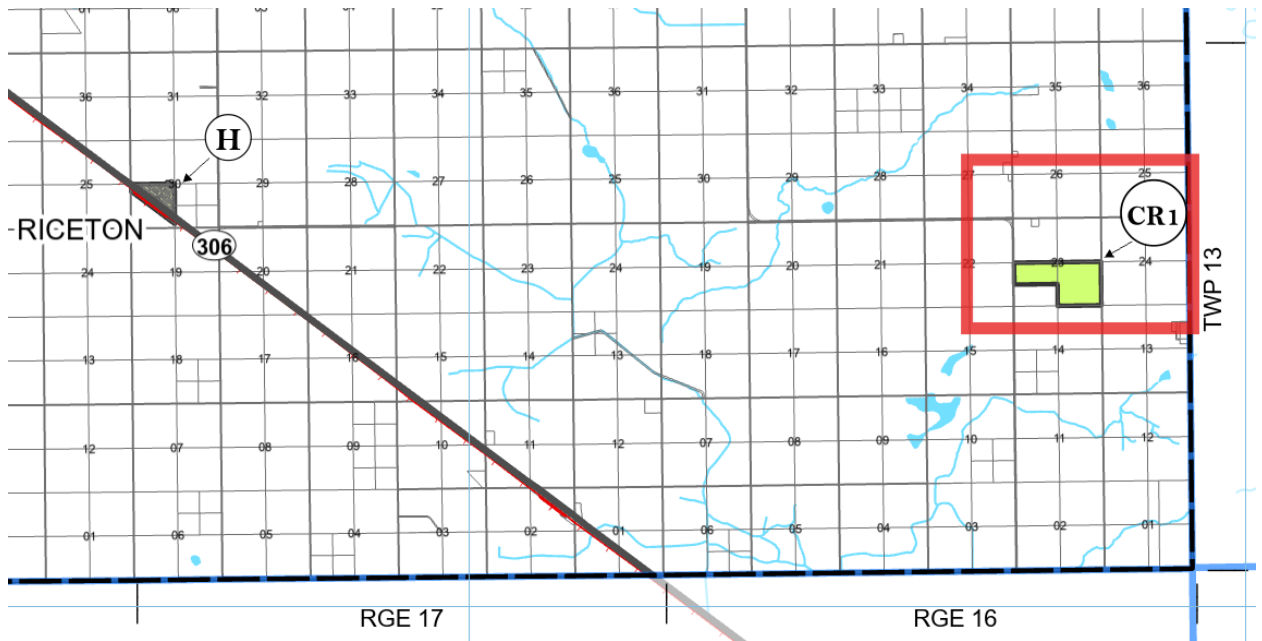

3. Delete and replace the General Zoning District Map in Section 15.0 Zoning Districts Maps with the Map attached hereto in Appendix A, which forms part of this bylaw.

4. This bylaw shall come into force on the date of final approval by the Minister of Government Relations.

Read a first time this 8th day of May, 2025
Read a second time this 10th day of June, 2025
Read a third time this 10th day of June 2025
Adoption of bylaw this 10th day of June 2025

Originally Signed By _____
Armond Gervais, Reeve



Originally Signed By _____
Lynette Herauf, Chief Administrative Officer

Certified a true copy of Bylaw 2025-01
adopted by resolution on the
10th day of June, 2025.

APPENDIX A

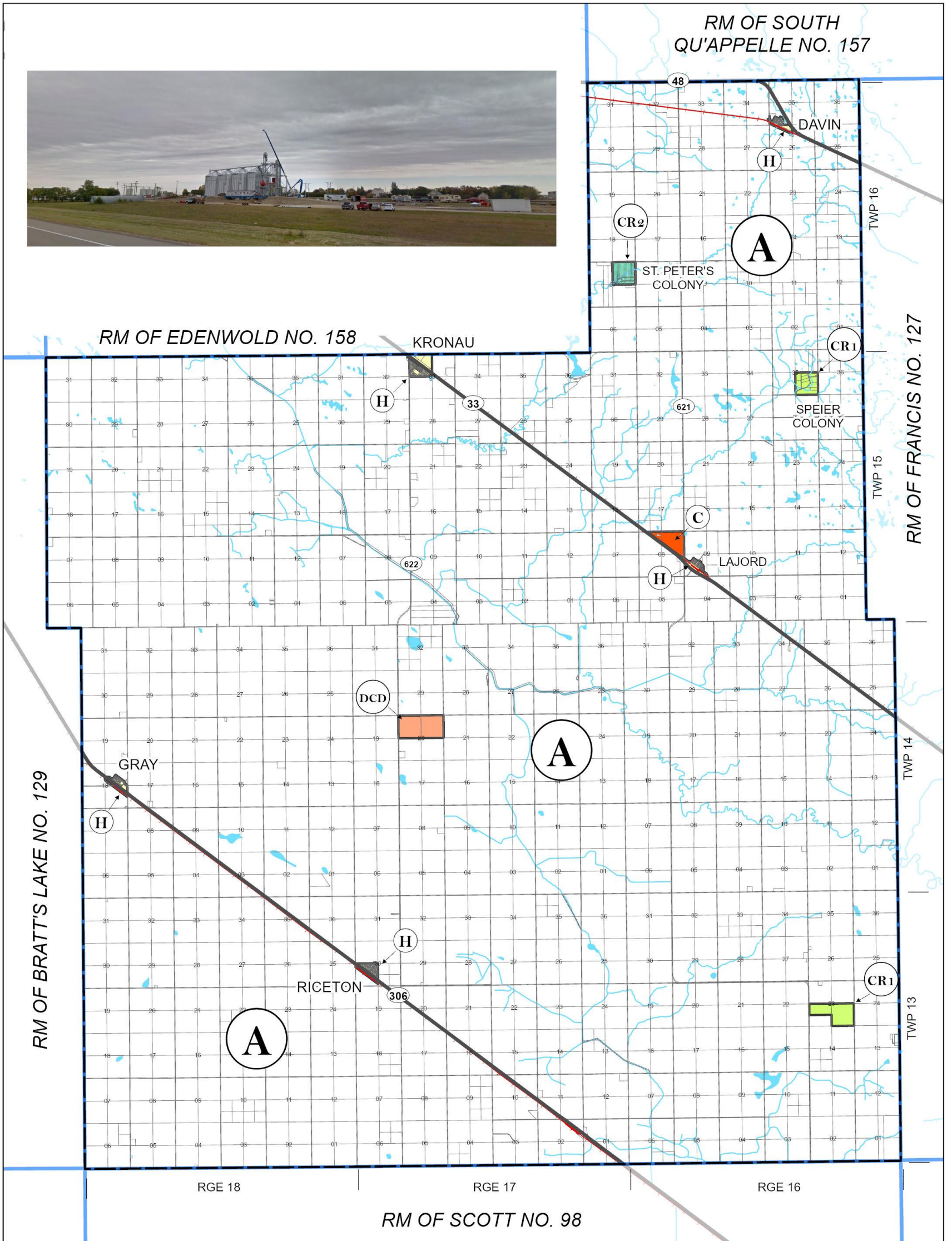

ZONING DISTRICT MAP
RM OF LAJORD NO. 128
"The Country of your Dreams"

THIS IS THE ZONING DISTRICT MAP
 REFERRED TO IN BYLAW No. 2022-13
 ADOPTED BY THE RM OF LAJORD No. 128

 REEVE

 ADMINISTRATOR
 APPROVED ON THE _____ DAY OF _____, 2023

MINISTRY OF GOVERNMENT RELATIONS

- | | | |
|-------------------------|-------------------------------|---------------|
| Zoning Districts | Agricultural - A | Major Highway |
| | Intensive Agricultural - I-A | Railway |
| | Country Residential 1 - CR1 | Watercourse |
| | Country Residential 2 - CR2 | Waterbody |
| | Hamlet - H | |
| | Commercial - C | |
| | Direct Control District - DCD | |

0 1.5 3 km

